



DigiBracket

Computer Bracket

- | | |
|------------------|-------------------------------|
| (EN) Manual | (HU) Használati utasítás |
| (DE) Handbuch | (PL) Podręcznik |
| (FR) Manuel | (CZ) Uživatelská příručka |
| (NL) Handleiding | (JP) 使用説明書 |
| (ES) Manual | (RU) Руководство пользователя |
| (PT) Manual | (SK) Manuál |
| (IT) Manuale | (NO) Håndbok |

BCP-59

Quick Start Manual (English)

Download the complete manual at www.BBBparts.com

- | | |
|--|--------------------------------|
| (EN) Computer bracket. | (HU) Rögzítőbilincs. |
| (DE) Computerhalterung. | (PL) Uchwyt licznika. |
| (FR) Support de compteur. | (CZ) Držák cyklocomputeru |
| (NL) Computer bracket. | (JP) コンピューターブラケット。 |
| (ES) Soporte de sujeción del computador. | (RU) Держатель велокомпьютера. |
| (PT) Suporte de ciclómetro. | (SK) Držiak komputeru. |
| (IT) Slitta computer. | (NO) Computerbrakett. |

MOUNTING BRACKET

1. The bracket can be installed on the stem as well as the handlebar. The bracket is pre-assembled in the handlebar position.
2. If you would like to have your computer on the stem, loosen the four screws on the bracket, rotate the bracket 90 degrees and tighten the four screws.
3. Pass two zip-ties through the bracket and around stem/handlebar. Cut off the excess length of the zip-ties.
4. Place the BBB computer in the bracket and rotate clockwise till you hear a "click" sound.

2nd bike setup

If you would like to use this bracket to set up the second bike option, download the complete computer manual at www.BBBparts.com.

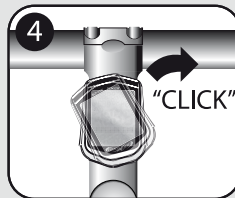
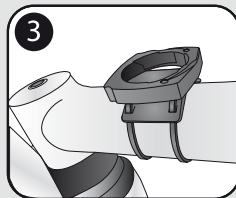
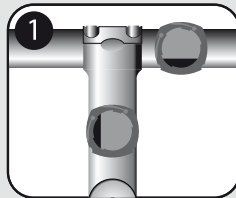

www.BBBPARTS.COM

© BBB Bike Parts

The specifications and designs may be changed without notice.
BBB has no responsibility for misprints or changed technical content.